

DOVE MANUFACTURING INC.
GCA 2000 3000

5062A
02/10/2006

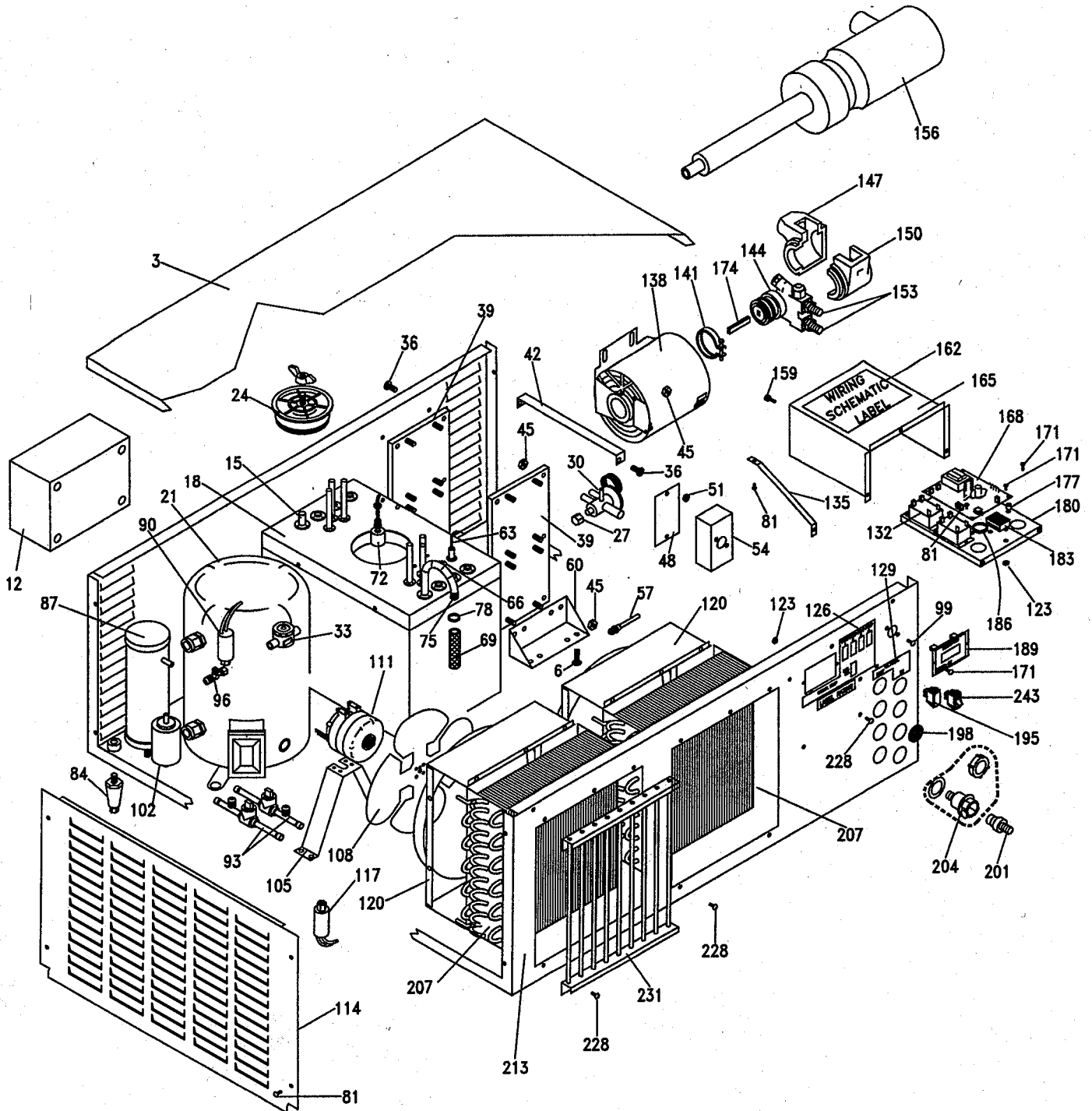

CORPORATE OFFICES

CLELAND SALES CORPORATION

11051 VIA EL MERCADO, LOS ALAMITOS, CA 90720
PHONE (562) 598-6616 FAX (562) 598-3858

PLANT

DOVE MANUFACTURING INC.

3440 S. Hwy W, WINFIELD, MO. 63389
PHONE (636) 528-8591 FAX (636) 528-8506

MGCA2.W 1 PARTS LISTS GCA 2000 3000

REB 02-01-06 / 02-10-06

ITEM	PART	CODE	DESCRIPTION
3	4738A	P	PART: CABINET COVER [CRESCO] - GCO2000
6	5087A	P	SCREW SS 1/4-20 X 3/4 SL HEX HD (SPN 04 0065 000)[ALLOY #SIMSSS14
12	5948A	P	COMP ELECTRICAL BOX FOR MTZ18 & MTZ22 [MCMaster #75065K13] - GCW,
15	4776A	M	PLUG GLYCOL TANK .50 DIA PICKUP/DISCHARGE OPENING (R 5903A) - GC
18	5779A	PA	TANK WATER ASSY TYPE 2 WITH THREE EVAP TUBES - GCA2000, 3000
21	5623A	P	COMP R404A 1.5HP MANEUROPE 208/230V [DANFOSS #MTZ18JA1VE] - GCW,
	5624A	P	COMP R404A 2.0HP MANEUROPE 208/230V [DANFOSS #MTZ22JC1] - GCW, GC
24	4407A	P	PLASTIC CAP GLYCOL FOR SS RESERVOIR TANK
27	5771A	P	REF VALVE ORIFICE #7 FOR TXV VALVE (DPN# 5681A)[DANFOSS #068U1037
	5971A	P	REF VALVE ORIFICE #6 FOR TXV VALVE (DPN# 5681A) [DANFOSS #068U103
30	5681A	P	REF VALVE TXV 404A 3/8 X 1/2 [DANFOSS #068U228700] - GC-EV ALL, B
33	5941A	P	REF SIGHT GLASS 3/8 SOLDER [DANFOSS #14-0143] - GCW, GCA
36	3904A	P	SCREW SS 1/4-20 X 3/4 SL PAN HD
39	4743A	P	PART: MOTOR WALL BRKT 2 PUMPS - GCO ALL
42	4742A	P	PART: MOTOR PUMP BRKT BRACE [ACU] - GCO2003, 2004
45	4373A	P	NUT SS 1/4-20 HEX WITH TOOTHED WASHER (SPN 18 9429 000)[ALLOY #NK
48	4729A	P	HANDY BOX COVER [MCMaster #71695K27]
51	2941A	P	NUT SS 10-32 HEX (SPN 39 8024 400)[ALLOY #NMSSS10F]
54	4728A	P	HANDY BOX 1 7/8" DEEP [MCMaster #71695K21]
57	4798A	P	VALVE REFRIG ACCESS CU W/CORE (5/PK)[UNITED REFRIGERATION #A31004
60	4741A	P	PART: MOTOR FLOOR MTG BRKT 2 PUMPS [ACU] - GCO1003, 2003, 2004
63	5733A	P	THERMISTOR W/EXTENDED LEADS - GLYCOL
66	5737A	M	PLUG GLYCOL TANK .31 DIA THERMOMETER OPENING (R 5902A) - GCO ALL
69	5900A	P	TUBING REINFORCED PVC NT 80 1/2 ID X 13/16 OD/FT [ADVANCED BEVERA
72	4781A	P	SWITCH FLOAT ASSY (OSPN 32 5288 000)
75	4779A	P	SS TUBE PICKUP/DISCHARGE W/.5" BARB [FITTINGS INC.] - GCO ALL
78	5727A	P	CLAMP HOSE STEPLESS 22.6 [MANITOWOC #16701041] - GLYCOL
81	3088A	P	SCREW SS 8-32 X 3/8 PH TRUSS HD (SPN 96 0653 000)[ALLOY #PTMSSS08
84	2637A	P	LEG CABINET 4" ADJ
87	5595A	PA	TANK RECEIVER ASSY 1/4 SWEAT NO VALVES [REFRIGERATION RESEARCH #2
90	5510A	P	SWITCH PRESSURE CONTROL LOW OPEN 20 CLOSE 45 [JOHNSTONE #B11-776]
93	5593A	P	REF VALVE MANUAL 3/8 SWEAT 1/4 TURN (ON TO OFF)[UNITED #38BVT]
96	5689A	P	BRASS ACCESS TEE 1/4" FLARE SWIVEL NUT ON RUN [JOHNSTONE #B13-512
99	3023A	P	SCREW SS 10-32 X 1/2 PH TRUSS HD
102	5940A	P	DRIER REFRIGERANT 3/8 SOLDER (DCL 083S)[DANFOSS #023Z5023] - GCW,
105	5322A	P	FAN BRKT 7.37" TO CENTER [EMS #L15962] - GLYCOL ALL
108	5325A	P	FAN BLADE 11" 28 DEGREE (REPLACES 5092A)[EMS #12371-5] - GLYCOL A
111	5324A	P	MOTOR FAN 230V 35W [EMS #ESPL35EM2] - GC1000, 2000
114	4744A	P	PART: PANEL ACCESS [CRESCO] - GC ALL
117	5448A	P	SWITCH PRESSURE CONTROL HIGH OPEN 400 CLOSE 300 [JOHNSTONE #B11-7
120	5944A	P	PART: CONDENSER SHROUD [CRESCO] - GCA1000 THRU 3000
123	4851A	P	NUT SS 6-32 KEPS (SPN 33 0181 000)
126	4823A	P	LABEL CONTROL PANEL - GC ALL
129	5007A	P	LABEL GLYCOL IN/OUT - GCO/GCW-500, 750, 1000
132	4651A	P	RELAY CIRCUIT BOARD - GCO1002
135	4771A	P	PART: THERMOSTAT BRKT SUPPORT - GCO ALL
138	4393A	P	MOTOR PUMP 1/3HP 115V/220V EMERSON [PROCON #828](CAN REPLACE 5049
141	4339A	P	CLAMP PUMP [PROCON #1113]
144	5414A	P	PUMP W/NYLON GLASS FILLED COUPLING [PROCON #102C100F11BB-130] - G
147	4898A	P	INSULATION PUMP RIGHT SIDE [LANCER #50-0113]
150	4899A	P	INSULATION PUMP LEFT SIDE [LANCER #50-0270]
153	5949A	P	BRASS CONNECTOR MALE 3/8 MPT X 1/2 BARB [CSC #125-86] - GC ALL
156	4790A	P	GLYCOL PRE-FILTER ASSY [CSC #000010] - GC ALL

MGCA2.W 1 PARTS LISTS GCA 2000 3000

REB 02-01-06 / 02-10-06

ITEM	PART	CODE	DESCRIPTION
159	5016A	P	BRASS SCREW 8-32 X 3/8 THUMB [ALLIED #16C37SK21]
162	5214A	P	LABEL WIRING SCHEMATIC CONTROL BOARD - GCA/GCW 1000, 2000, 3000
165	4751A	P	PART: SHIELD FOR THERM ELEC [CRESCO] - GCO750, 1000, 2000
168	4657A	P	BOARD CIRCUIT (USES 4651A RELAY - EXTERNAL) - 1 & 1 1/2 HP GLYCOL
171	3190A	P	SCREW MA 6-32 X 3/8 PH PAN SS (SPN 34 3326 000)[ALLOY #PPMSSS06C0
174	5416A	P	PUMP NYLON GLASS FILLED COUPLING [PROCON #1143-2]
177	3814A	P	SPACER .375 DIA X .187" LONG [HEYCO X332] - CP, CPA, GCR
180	4770A	P	PART: THERMOSTAT BRKT [CRESCO] - GCO ALL
183	5220A	A	TERMINAL BLOCK ASSY - GC1000, 2000
186	5776A	P	BUSHING SNAP SB-1250-16 [H.W. ECKHARDT #2201]
189	4656A	P	DISPLAY DIGITAL - GLYCOL CIRCUIT BOARDS
195	4775A	P	PLUG BUTTON .562 X 1.125 HOLE (SPN 96 0913 000)[ELECTRIC SWITCHES
198	4774A	P	PLUG 1.25 DIA CABINET HOLE RUBBER [CAPLUGS] - GCO ALL
201	5567A	P	FITTING HOSE BARB INSERT STRAIGHT 1/2" [NOR-CAL #HFC-228-35]
204	4662A	P	FITTING HOSE BARB BODY BULKHEAD PANEL MOUNT 1/2" [NOR-CAL #HFC-16
207	5943A	P	CONDENSER 12 X 11 FINNED AREA 4-ROW 3.5" DEEP [CUSTOM COILS] - GC
213	4736A	P	PART: CABINET [CRESCO] - GCO2000
228	3024A	P	SCREW SS 8-32 X 1/2 PH TRUSS HD (SPN 34 3842 000)[ALLOY #PTMSSS08
231	4829A	P	PART: GRILLE CONDENSER [CRESCO] - GCO
243	5229A	P	SWITCH REFRIGERATION [WESGARDE #C1300XRBBR-602AR] - GLYCOL

Parts Not Shown GCA 2000 3000

	4663A	PA	BOX SHIPPING CARTON ASSY 40-INCH (R 4664A (4), 4665A (4), 4668A (
	5946A	P	COMP CAPACITOR RUN 1.5HP (MTZ18) 208/230V [DANFOSS #7304533] - GC
	5947A	P	COMP CAPACITOR RUN 2.0HP (MTZ22) 208/230V [DANFOSS #7304522] - GC
	5942A	P	COMP CAPACITOR START/RELAY 1.5HP (189-227uF)[SEALED UNIT PARTS #S
	5899A	P	COMP CAPACITOR START/RELAY 2.0HP (233-280uF)[SEALED UNIT PARTS #S
	5629A	P	COMP COPPER SOLDER SLEEVES 1 1/4" MPT 5/8 SOLDER [DANFOSS #815301
	5628A	P	COMP COPPER SOLDER SLEEVES 1" MPT 1/2 SOLDER [DANFOSS #8153007]
	5627A	P	COMP COPPER SOLDER SLEEVES 1" MPT 3/8 SOLDER [DANFOSS #8153010]
	5901A	P	COMP CRANKCASE HEATER KIT 35W 200/600V [DANFOSS #PTC] - GCW, GCA3
	5558A	P	CONNECTOR ROMEX 1/2" CONDUIT [UNITED #N1320] - GCR
	5631A	P	LABEL WIRING SCHEMATIC - GCA/GCW2000V, 3000V W/MANEUROPE COMP
	4719A	P	LABEL WIRING SCHEMATIC - GCA/GCW 1000, 2000
	4822A	P	LABEL "1 2 3 4" - GCO
	5062A	P	MANUAL SERVICE - GC2003, 2004
	5163A	P	REF DISTRIBUTOR 3-CIRUITS [SPORLAN VALVE #1613-3-1/4-4][ALCO #4-4
	4803A	P	WIRE BLU 13" THERM ELEC/TB5 [LAMCOR]
	4830A	P	WIRE BLU 14" HANDY BOX/TB4 [LAMCOR] - GC1000, 2000
	4804A	P	WIRE BLU 18" GLYCOL MTR1/MTR3 OR MTR2/MTR4 [LAMCOR]
	4805A	P	WIRE BLU 32" TB5/MTR1 OR TB6/MTR 2 [LAMCOR]
	4806A	P	WIRE BLU 48" COMP RELAY/TB6 [LAMCOR]
	4807A	P	WIRE BRN 8" GLYCOL RELAY 0 OR 1/THERM ELEC [LAMCOR]
	4808A	P	WIRE BRN 9" GLYCOL RELAY 2 & 6/TB2 [LAMCOR]
	4809A	P	WIRE BRN 10" COMP RELAY COIL/THERM ELEC [LAMCOR]
	4923A	P	WIRE BRN 10" GLYCOL RELAY 4 OR 8/MTR SWITCH 1 OR 2 [LAMCOR]
	4810A	P	WIRE BRN 10" MTR SWITCH 1 OR 3/MTR SWITCH 2 OR 4 [LAMCOR]
	4811A	P	WIRE BRN 13" THERM ELEC/TB1 [LAMCOR]
	4906A	P	WIRE BRN 14" HANDY BOX/TB1 [LAMCOR] - GC1000, 2000
	4812A	P	WIRE BRN 16" COMP RELAY COIL/REF SWITCH [LAMCOR]
	4813A	P	WIRE BRN 16" REF SWITCH/THERM ELEC [LAMCOR] - GC1000, 2000

MGCA2.W 1 PARTS LISTS GCA 2000 3000

REB 02-01-06 / 02-10-06

ITEM PART CODE

DESCRIPTION

ITEM	PART	CODE	DESCRIPTION
	4814A	P	WIRE BRN 17" COMP RELAY 2 OR 6/TB2 [LAMCOR]
	4816A	P	WIRE BRN 24" MTR 3 OR 4/MTR SWITCH [LAMCOR]
	4973A	P	WIRE BRN 32" MTR 1 OR MTR 2/MTR SWITCH [LAMCOR]
	4818A	P	WIRE BRN JUMPER F 4.5" [LAMCOR] - GCO, GCW
	5006A	P	WIRE GND GRN 14" 5/64 INS [LAMCOR] - GC1000, 2000
	5722A	P	WIRE RED 35" RUNCAP 5/COMP R [LAMCOR] - GC3000
	5114A	P	WIRE SPIRAL WRAP 3/8" BLACK/FT (100'/SPOOL) [MCMASTER #7432K42]
	5723A	P	WIRE YELLOW 35" RUNCAP 2/COMP S [LAMCOR] - GC3000

INDICATOR LIGHT IDENTIFICATION (INDICATES CONDITION OF SYSTEM WHEN LIT)

- 1) RED - HOT/COLD RUN LIGHT: INDICATES COMPRESSOR IS RUNNING
- 2) RED - SENSOR FAILURE LIGHT: INDICATES SENSOR FAILED
- 3) YELLOW - PRESSURE SWITCH LIGHT: INDICATES REFRIGERANT PRESSURE TOO HIGH OR TOO LOW
- 4) GREEN - FLOAT SWITCH LIGHT: INDICATES LOSS OF GLYCOL

GCA/GCW 1000 2000 3000

