

DOVE GC-50

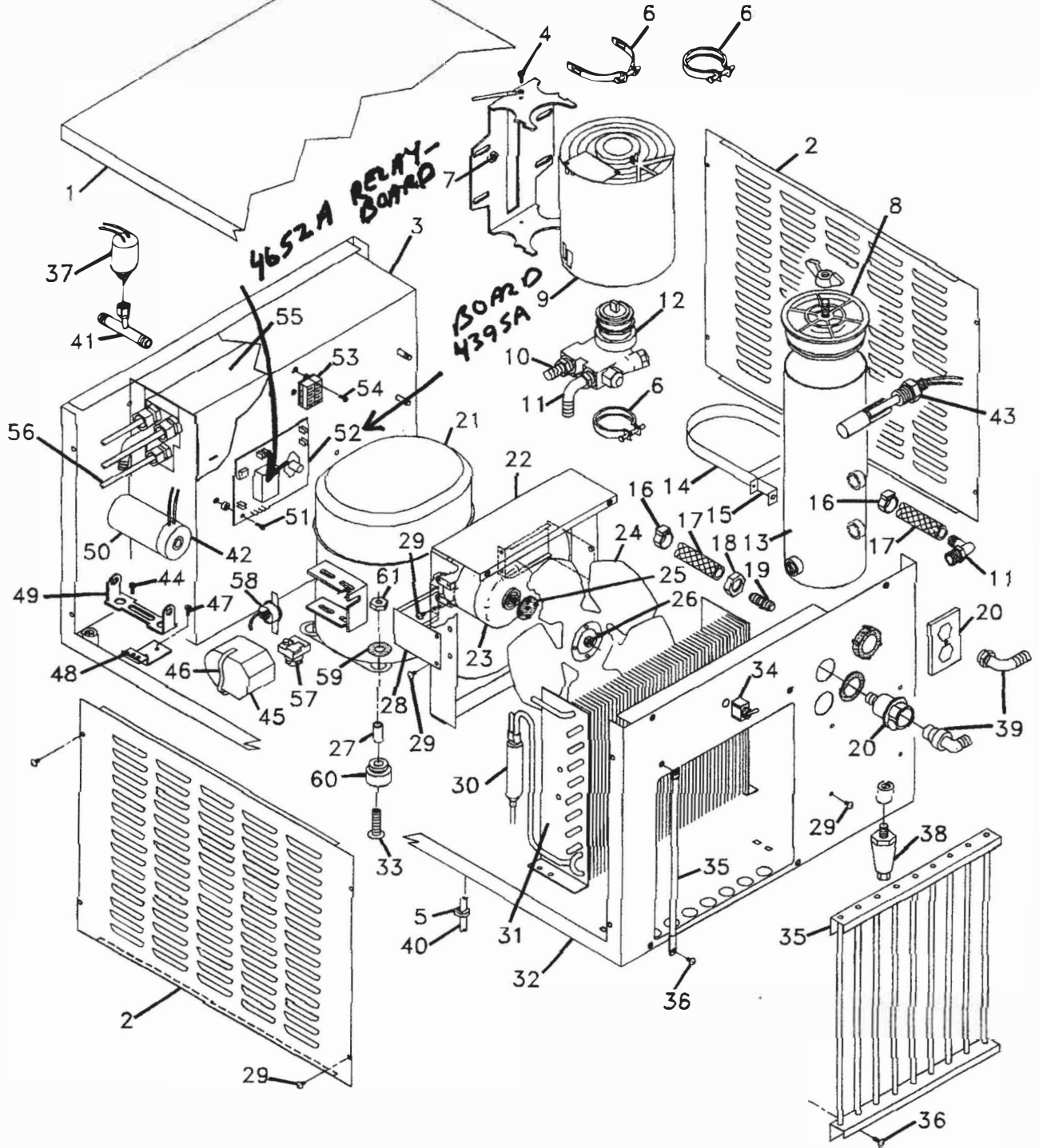

GC-50 PARTS LIST

ITEM#	PART#	DESCRIPTION	ITEM#	PART#	DESCRIPTION
1	4244A	CABINET COVER	40	4054A	LINECORD (BEFORE FEB'02)
2	4240A	SIDE PANEL, R/H, L/H		4940A	LINECORD (AFTER JAN'02)
3	4241A	OUTER TANK PANEL	41	4403A	TEE, 1/2" BARB X 1/4" FLARE, SS
3	4242A	INNER TANK PANEL	42	4597A	CAP, CAPACITOR, ASPERA
4	2467A	GROUND WIRE SCREW	43	4397A	LOW LEVEL SWITCH
5	2662A	STRAIN RELIEF, LINE CORD	44	4600A	SCREW, CAPACITOR MOUNT, ASPERA
6	4339A	CLAMP, PROCON PUMP	45	3085A	COVER, RELAY, COMPRESSOR, ASPERA
7	4373A	NUT, PUMP MOTOR MOUNTING	46	3086A	STRAP, COVER, RELAY, ASPERA
8	4407A	RESERVOIR CAP	47	4599A	SCREW, CAPACITOR MOUNT BRKT, ASPERA
9	4393A	MOTOR PUMP 115V/220V	48	4595A	MOUNT BRKT, CAPACITOR, LOWER, ASPERA
10	4569A	1/2 BARB X 3/8 MPT FITTING, NYLON	49	4596A	MOUNT BRKT, CAPACITOR, UPPER, ASPERA
11	4329A	1/2 BARB X 3/8 MPT ELBOW, NYLON	50	4555A	CAPACITOR 115 V, ASPERA ONLY
12	5414A	PUMP PROCON		4630A	CAPACITOR 220 V, ASPERA ONLY
13	4293A	PRIMING RESERVOIR	51	2712A	SCREW, CONTROL BOARD MOUNT (BEFORE FEB'02)
14	4247A	RESERVOIR STRAP, OUTER		4231A	SCREW, CONTROL BOARD MOUNT (AFTER JAN'02)
15	4294A	RESERVOIR STRAP, INNER		3814A	SPACER, CONTROL BOARD MOUNT (BEFORE FEB'02)
16	4560A	OETIKER CLAMP, 19.8 MM		4468A	SPACER, CONTROL BOARD MOUNT (AFTER JAN'02)
17	4228A	TUBING 1/2" ID, PER FOOT	52	4395A	CONTROL BOARD
18	4263A	NUT, BULKHEAD, SS (BEFORE FEB'02)	53	4245A	TERMINAL BLOCK ASSY
19	4196A	FITTING, BULKHEAD, 1/2" BARB X 1/2" MALE FLARE SWIVEL ELBOW (BEFORE FEB'02)	54	3190A	SCREW, TERMINAL BLOCK MOUNT
20	4419A	BRACKET, BULKHEAD FITTING (BEFORE FEB'02)	55	4248B	WATER TANK (BEFORE FEB'02)
	4462A	BULKHEAD FITTING QUICK-RELEASE (AFTER JAN'02)		5739A	WATER TANK (AFTER JAN'02)
21	4192A	COMPRESSOR 115V TECUMSEH	56	4396A	THERMISTOR
	4424A	COMPRESSOR 220V TECUMSEH	57	4553A	RELAY, ASPERA, 115 VOLT RELAY, ASPERA, 220 VOLT RELAY, TECUMSEH, 115 VOLT RELAY, TECUMSEH, 220 VOLT
	4552A	COMPRESSOR 115V ASPERA	58	4554A	OVERLOAD, ASPERA, 115 VOLT OVERLOAD, ASPERA, 220 VOLT OVERLOAD, TECUMSEH, 115 VOLT OVERLOAD, TECUMSEH, 220 VOLT
	4556A	COMPRESSOR 220V ASPERA	59	2715A	WASHER, COMPRESSOR MOUNT
22	4317A	SHROUD, CONDENSER	60	3433A	GROMMET, COMPRESSOR, TECUMSEH
23	5323A	FAN MOTOR, 115V		4598A	GROMMET, COMPRESSOR, ASPERA
	5324A	FAN MOTOR, 230V	61	2711A	NUT, COMPRESSOR MOUNT
24	4319A	FAN BLADE			
25	3340A	RUBBER WASHER, FAN BLADE			
26	3098A	SPEED NUT, FAN BLADE			
27	3434A	COMPRESSOR MOUNTING SLEEVE			
28	4320A	BRACKET, FAN MOTOR MOUNT			
29	3088A	SCREW			
30	3998A	DRIER, R134a			
31	4316A	CONDENSER			
32	4243B	CABINET, BASE			
33	3933A	CARRIAGE BOLT, COMP. MOUNT			
34	2436A	TOGGLE SWITCH, POWER			
35	4421A	GUARD CONDENSER TUBE (BEFORE FEB'02)			
	5738A	GUARD CONDENSER GRILLE (AFTER JAN'02)			
36	4223A	SCREW CONDENSER GUARD (BEFORE FEB'02)			
	3088A	SCREW CONDENSER GUARD (AFTER JAN'02)			
37	4358A	PRESSURE SWITCH			
38	2637A	LEG, 4"			
39	4404A	ELBOW 1/2" BARB X 1/2" FLARE (BEFORE FEB'02)			
	4661A	ELBOW PLASTIC, FITS 4662A (AFTER JAN'02)			

PARTS NOT SHOWN:

- SHIPPING CARTON COMPLETE
- 4618A PARTS & SERVICE MANUAL
- 4420A DECAL, REFRIGERATION POWER
- 4734A MOTOR & PUMP ASSY 110 VOLT
- 4735A MOTOR & PUMP ASSY 220 VOLT
- 5416A COUPLER, PUMP GLASS-FILLED